

SECTION 10

URBAN RESIDENTIAL 4 ZONE (UR4)

	Page
10.1 <u>Permitted Uses</u>	10 - 1
10.2 <u>Zone Regulations</u>	10 - 1
10.3 <u>Site and Area Specific Regulations</u>	10 - 5

10.1 Permitted Uses

Accessory uses and buildings.

Apartment dwellings containing not more than **12** dwelling units.

Place of Worship.

Converted dwellings.

Duplex dwellings.

(135/2006)

Group homes.

Homes for the aged.

Multiple attached dwellings.

Retirement homes.

Rooming or boarding houses.

Semi-detached dwellings.

(139/2002)

Single detached dwellings.

Women's shelters.

10.2 Zone Regulations

10.2.1 Multiple Attached Dwellings

- | | | | |
|-----|-------------------|-----------|---------------------------------------|
| (1) | Lot Area: | (minimum) | 300m² for each unit |
| (2) | Lot Frontage: | (minimum) | 30m |
| (3) | Front Yard Depth: | (minimum) | 9m |

- | | | | |
|-----|-------------------------------|-----------|---|
| (4) | Side Yard Widths: | (minimum) | 3m (each side) , there is no interior side yard required along the common lot line where dwelling units are attached by a common wall, there is an interior side yard of 0.6m required along the common lot line for those portions of the dwelling units which are not attached by a common wall |
| (5) | Rear Yard Depth: | (minimum) | 7.5m |
| (6) | Lot Coverage: | (maximum) | 30% |
| (7) | Height: | (maximum) | 12m |
| (8) | Landscaped Open Space: | (minimum) | 40% |
| (9) | Private Outdoor Amenity Area: | (minimum) | <p>A private outdoor amenity area shall be provided immediately adjacent to each dwelling unit for the private use of the occupants of the dwelling unit. The private outdoor amenity area shall:</p> <ul style="list-style-type: none"> (a) have an area of not less than 35m²; (b) have a minimum width equal to the width of the dwelling unit; (c) be accessible from the dwelling unit; and (d) be bordered by a wall or wood privacy fence along a minimum of 90% of its perimeter, such wall or fence shall not be less than 1.5m in height. |

10.2.2 Apartment Dwelling

- | | | | |
|-----|-----------|-----------|---|
| (1) | Lot Area: | (minimum) | a minimum lot area of 650m² for the first three dwelling units and a minimum lot area of 100m² for each additional dwelling unit. |
|-----|-----------|-----------|---|

(2)	Lot Frontage:	(minimum)	20m
(3)	Front Yard Depth:	(minimum)	9m
(4)	Side Yard Widths:	(minimum)	5m (each side)
(5)	Rear Yard Depth:	(minimum)	7.5m
(6)	Lot Coverage:	(maximum)	35%
(7)	Height:	(maximum)	12m
(8)	Landscaped Open Space:	(minimum)	40%

10.2.3 Converted Dwellings

Within the "UR4" zone a single detached, semi-detached or duplex dwelling which conforms to this By-law may be converted to create one or more additional dwelling units subject to the following regulations:

- (1) A detached-dwelling, located in the areas as shown on Zoning Map - Parts 38, 39, 42, 43, 53, 54, 56, 57, 66 and 67, may be converted to create more than 2 dwelling units, subject to Section 9.2.2(5).

10.2.4 Women's Shelter

(14/2010)

- (1) The regulations set out in section 7.2.1 shall apply.

10.2.5 Homes for the Aged, Retirement Home

- (1) The regulations set out in Section 11.2.2 shall apply.

10.2.6 Rooming or Boarding House

(1)	Lot Area:	(minimum)	550m²
(2)	Lot Frontage:	(minimum)	18m
(3)	Front Yard Depth:	(minimum)	6m
(4)	Side Yard Widths:	(minimum)	2m (each side)
(5)	Rear Yard Depth:	(minimum)	7.5m
(6)	Lot Coverage:	(maximum)	35%
(7)	Height:	(maximum)	12m
(8)	Landscaped Open Space:	(minimum)	40%

10.2.7 Single Detached Dwellings

- (1) The regulations set out in Section 7.3.1 shall apply.

10.2.8 Duplex Dwellings and Semi-detached Dwellings

(135/2006)

- (1) The regulations set out in Section 8.3.1 shall apply.

10.2.9 Places of Worship

(135/2006)

- (1) The regulations set out in Section 7.2.2 shall apply.

10.2.10 Group Homes

(14/2010)

- (1) The regulations set out in [Section 3.16](#) shall apply.

10.3 Site and Area Specific Regulations

The following site and area specific zones shall be subject to the preceding permitted uses and zone regulations except where those permitted uses and regulations are varied by the provisions of these site and area specific zones.

	Page		Page		Page
<u>UR4-1</u>	10 - 5	<u>UR4-11</u>	10 - 12	<u>UR4-20</u>	10 - 20
<u>UR4-2</u>	10 - 6	<u>UR4-12</u>	10 - 13	<u>UR4-21</u>	10 - 22
<u>UR4-3</u>	10 - 6	<u>UR4-13</u>	10 - 14	<u>UR4-22</u>	10 - 23
<u>UR4-4</u>	10 - 7	<u>UR4-14</u>	10 - 15	<u>UR4-23</u>	10 - 25
<u>UR4-5</u>	10 - 7	<u>UR4-15</u>	10 - 16	<u>UR4-24</u>	10 - 25
<u>UR4-6</u>	10 - 7	<u>UR4-16</u>	10 - 18	<u>UR4-25</u>	10 - 26
<u>UR4-7</u>	10 - 8	<u>UR4-10</u>	10 - 11	<u>UR4-26</u>	10 - 26
<u>UR4-8</u>	10 - 9	<u>UR4-17</u>	10 - 19	<u>UR4-27</u>	10 - 28
<u>UR4-9</u>	10 - 10	<u>UR4-18</u>	10 - 19	<u>UR4-28</u>	10 - 28
<u>UR4-10</u>	10 - 11	<u>UR4-19</u>	10 - 20		

10.3.1 UR4-1 (See Zoning Map Parts 23 and 47)

10.3.1.1 Site Zone Regulations - Multiple Attached Dwellings

(1)	Lot Area:	(minimum)	250m² per dwelling unit
(2)	Lot Frontage:	(minimum)	30m
(3)	Side Yard Widths:	(minimum)	3m (each side) provided however, that where there is an attached garage or carport, the minimum side yard width (each side) shall be 1.5m
(4)	All Other Regulations:		the regulations set in Section 10.2.1 shall apply

10.3.2 **UR4-2** (See Zoning Map Part 62)

10.3.2.1 **Site Zone Regulations - Multiple Attached Dwellings**

- | | | | |
|-----|------------------------|-----------|--|
| (1) | Lot Area: | (minimum) | 185m² per dwelling unit |
| (2) | Lot Frontage: | (minimum) | 30m |
| (3) | Side Yard Widths: | (minimum) | 3m (each side)
provided however, that where there is an attached garage or carport, the minimum side yard width (each side) shall be 1.5m |
| (4) | All Other Regulations: | | the regulations set out in Section 10.2.1 shall apply |
-

10.3.3 **UR4-3** (See Zoning Map Part 30)

10.3.3.1 **Permitted Uses**

- (1) Accessory uses and buildings.
- (2) Multiple attached dwellings.
- (3) Semi-detached dwellings.

10.3.3.2 **Site Zone Regulations**

- | | | | |
|-----|-----------------|-----------|---|
| (1) | Parking Spaces: | (minimum) | 62 parking spaces to be paved and drained |
| (2) | Walkway: | (minimum) | 3m along the north limit of the lot from Roger Street to High Park School, the walkway is to be fenced, paved and provided with gates at both ends |
| (3) | Fencing: | (minimum) | all existing wood privacy and chain link fencing shall be maintained |
| (4) | Height: | (maximum) | 2 storeys |
-

10.3.4 UR4-4 (See Zoning Map Part 56)

10.3.4.1 Permitted Uses

- (1) Group homes for mentally challenged adults.

10.3.4.2 Site Zone Regulations - Group Home

- | | | | |
|-----|------------------------|-----------|---|
| (1) | Number of Residents: | (maximum) | 15 residents over the age of 16 excluding supervisory staff |
| (2) | Fencing: | (minimum) | 1m high hedge or opaque privacy fence along the east property line |
| (3) | Landscaped Open Space: | (minimum) | the existing landscaped open space shall be maintained |
| (4) | Signs: | (minimum) | no signs identifying the use are permitted |

10.3.5 UR4-5 (See Zoning Map Part 56)

10.3.5.1 Permitted Uses

- (1) Social or service clubs and office space.

10.3.5.2 Site Zone Regulations - Social or Service Club and Office Space

- | | | | |
|-----|---------------------------|-----------|---|
| (1) | Building Restrictions: | (minimum) | there shall be no increase in the total floor area of the building |
| (2) | Front & Rear Yard Depths: | (minimum) | the existing setbacks shall be maintained |
| (3) | Office Use Restriction: | (minimum) | office use shall be restricted to the basement floor and shall be for non-medical purposes only |

10.3.6 UR4-6 (See Zoning Map Part 66)

(50/2018)

10.3.6.1 Permitted Uses

- (1) Multiple dwelling containing **3** dwelling units
- (2) Those uses permitted in Section 10.1

10.3.6.2 Site Zone Regulations

- | | | | |
|-----|-----------|-----------|--------------------------------------|
| (1) | Lot Area: | (minimum) | as it existed on the date of passing |
|-----|-----------|-----------|--------------------------------------|

(2)	Lot Frontage:	(minimum)	of this by-law as it existed on the date of passing of this by-law
(3)	Front & Rear Yard Depths:	(minimum)	as existing on the date of passage of this By-law
(4)	Side Yard Widths:	(minimum)	as existing on the date of passage of this By-law
(5)	Lot Coverage:	(maximum)	as existing on the date of passage of this By-law
(6)	Height:	(minimum)	2 storeys
(7)	Landscaped Open Space:	(minimum)	30%
(8)	Parking:	(minimum)	1.5 spaces per dwelling unit
(9)	Planting Strips:	(minimum)	1.8m along the north lot line and 1.2m along the east lot line adjacent to the parking area

10.3.7 UR4-7 (See Zoning Map Part 41)

10.3.7.1 Permitted Uses

- (1) Multiple attached dwellings.

10.3.7.2 Site Zone Regulations

- | | | | |
|-----|------------------------|-----------|--|
| (1) | Height: | (maximum) | 2 storeys |
| (2) | Fencing: | (minimum) | an opaque wood, brick or stone
fence at least B in height shall be
maintained along the side and rear
lot lines of the lot where any parking
area is adjacent to such lot line |
| (3) | All Other Regulations: | | the regulations set out in Section 10.2.1 |
-

10.3.8 UR4-8 (See Zoning Map Part 61)

10.3.8.1 Permitted Uses

- (1) Accessory uses and buildings.
- (2) Multiple attached dwellings.
- (3) Public open space.
- (4) Semi-detached dwellings.
- (5) Single detached dwellings.

10.3.8.2 Site Zone Regulations

- | | | | |
|-----|-------------------|-----------|--|
| (1) | Lot Area: | (minimum) | - 510m² for single detached dwellings
- 650m² for semi-detached dwellings
- 185m² for each multiple attached dwelling unit |
| (2) | Lot Frontage: | (minimum) | - 16m for single detached dwellings
- 21m for semi-detached dwellings
- 21m for the first 3 dwelling units plus 6m for each additional dwelling unit (for a multiple attached dwelling) |
| (3) | Front Yard Depth: | (minimum) | - 7.5m for a single detached and semi-detached dwelling
- 4.5m for a multiple attached dwelling |
| (4) | Side Yard Widths: | (minimum) | - single detached and semi-detached dwellings shall provide 1.2m on one side and 3m on the other side, except that where there is an attached garage or carport, the minimum side yards shall be 1.2m on both sides
- multiple attached dwellings shall provide 4.5m on each side, except that where there is an attached garage or carport or common areas to a joint off-street parking area, the minimum side yards shall be 1.5m |
| (5) | Rear Yard Depth: | (minimum) | 7.5m |
| (6) | Lot Coverage: | (maximum) | 35% |
| (7) | Height: | (maximum) | 10.5m |

10.3.9 UR4-9 (See Zoning Map Part 61)

10.3.9.1 Permitted Uses

- (1) Semi-detached dwellings.

10.3.9.2 Site Zone Regulations

(1)	Lot Area:	(minimum)	650m²
(2)	Lot Frontage:	(minimum)	17m
(3)	Front Yard Depth:	(minimum)	7.5m
(4)	Side Yard Widths:	(minimum)	1.2m on one side and 3m on the other side, except where there is an attached garage or carport, the minimum side yards shall be 1.2m
(5)	Rear Yard Depth:	(minimum)	7.5m
(6)	Lot Coverage:	(maximum)	35%
(7)	Height:	(maximum)	10.5m

10.3.10 UR4-10 (See Zoning Map Part 61)

10.3.10.1 Permitted Uses

- (1) Semi-detached dwellings.

10.3.10.2 Site Zone Regulations

- (1) Same as regulations set out in Section 10.3.9.2
- (2) Notwithstanding Section 3.37(5)(e) of this By-law, the driveway on the lot described as Part of Lot 11, Registered Plan 726, described as Part 1, Plan 25R6102 shall be permitted to be constructed in compliance with the following diagram:

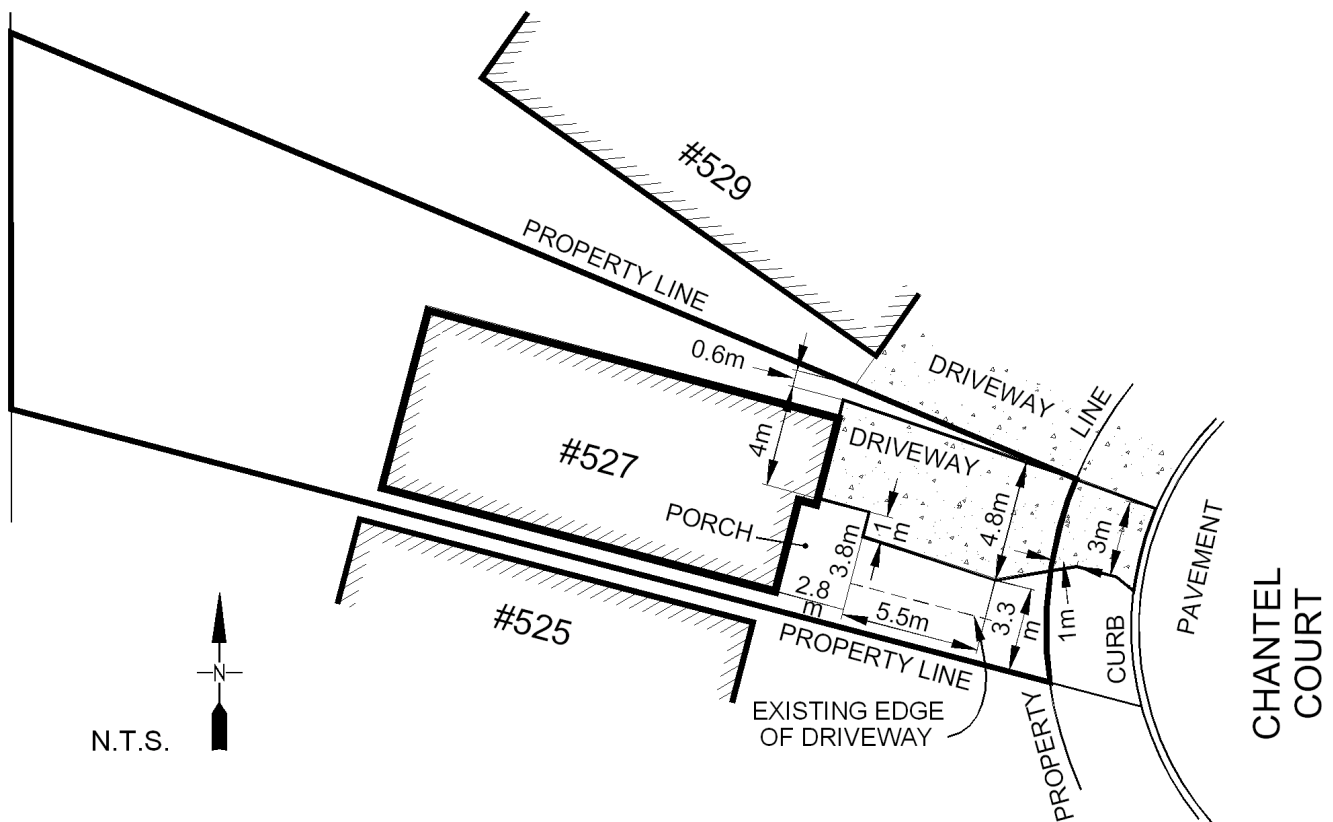

10.3.11 UR4-11 (See Zoning Map Parts 31 and 47)

10.3.11.1 Permitted Uses

- (1) Accessory uses and buildings.
- (2) Multiple-attached dwellings (attached above, below or both above and below grade).
- (3) Semi-detached dwellings (attached above, below or both above and below grade).

10.3.11.2 Site Zone Regulations

- | | | | |
|-----|-------------------|-----------|---|
| (1) | Lot Area: | (minimum) | <ul style="list-style-type: none"> - 240m² per dwelling unit for semi-detached dwellings attached above, below or both above and below grade and multiple attached dwellings attached below grade only - 185m² per dwelling unit for multiple attached dwelling attached above or both above and below grade |
| (2) | Lot Frontage: | (minimum) | <ul style="list-style-type: none"> - 8m per dwelling unit for semi-detached dwellings attached above, below or both above and below grade and multiple attached dwellings attached below grade - 6m per dwelling unit for multiple attached dwellings attached above or both above and below grade |
| (3) | Front Yard Depth: | (minimum) | 7.5m |
| (4) | Rear Yard Depth: | (minimum) | 7.5m |
| (5) | Side Yard Widths: | (minimum) | <ul style="list-style-type: none"> - 1.2m for semi-detached dwellings attached above grade or both above and below grade, except that no interior side yard shall be provided on the side where dwelling units are attached together by a common wall - 1.2m on one side and 0.6m on the other side for semi-detached dwellings attached below grade - 1.2m on one side and 0m on the other side provided at least 1.2m separation is maintained between dwelling units for multiple attached dwellings attached below grade |

- **3m** for multiple attached dwellings attached above grade, except that no side yard shall be required where dwelling units are attached together
 - **3m** for the end units of a group of multiple attached dwelling units attached both above and below grade, except that no interior side yard shall be provided on the side where dwellings are attached by a common wall.
- | | | | |
|-----|-----------------------|-----------|---|
| (6) | Lot Coverage: | (maximum) | 35% |
| (7) | Height: | (maximum) | 10.5m |
| (8) | Parking Requirements: | (minimum) | 1 private garage for each dwelling unit, attached to the dwelling unit, any vehicular entrance of which shall be setback not less than 6m from the front lot line and not less than 6m from any side lot line immediately adjoining a street |

10.3.12 UR4-12 (See Zoning Map Part 63)

10.3.12.1 Permitted Uses

- (1) Accessory uses and buildings.
- (2) Multiple attached dwellings attached above or both above and below grade.
- (3) Semi-detached dwellings attached above or both above and below grade.

10.3.12.2 Site Zone Regulations

- | | | | |
|-----|-------------------|-----------|--|
| (1) | Lot Area: | (minimum) | <ul style="list-style-type: none"> - 480m² for each set of 2 semi-detached dwelling units - 740m² for each set of 4 multiple attached dwelling units |
| (2) | Lot Frontage: | (minimum) | <ul style="list-style-type: none"> - 8m per semi-detached dwelling unit - 6m per multiple attached dwelling unit |
| (3) | Front Yard Depth: | (minimum) | 4.5m for semi-detached and multiple attached dwellings, except that where an attached garage has a vehicular entrance that faces a municipal street, a minimum front |

(4)	Side Yard Widths:	(minimum)	yard setback of 5.75m shall be provided for the garage only 1.2m for semi-detached dwellings, except that no interior side yard shall be provided on the side where the dwelling units are attached by a common wall.
(5)	Rear Yard Depth:	(minimum)	7.5m
(6)	Lot Coverage:	(maximum)	40%
(7)	Height:	(maximum)	10.5m
(8)	Landscaped Open Space:	(minimum)	40%
(9)	Parking Requirements:	(minimum)	1 private garage per dwelling unit, attached to the dwelling unit

10.3.13 UR4-13 (See Zoning Map Part 10)

10.3.13.1 Permitted Uses

- (1) Multiple attached dwellings.

10.3.13.2 Site Zone Regulations

(1)	Lot Area:	(minimum)	160m² for each dwelling unit
(2)	Lot Frontage:	(minimum)	6m for each dwelling unit
(3)	Front Yard Depth:	(minimum)	4.5m , except that any vehicular entrance to an attached garage shall be located less than 6m from the front lot line.
(4)	Side Yard Widths:	(minimum)	1.2m where a dwelling abuts a Commercial zone and 3m where a dwelling abuts a Residential zone 3m exterior side yard, except that any vehicular entrance to an attached garage shall be located not less than 6m from any flanking street
(5)	Lot Coverage:	(maximum)	40%
(6)	Height:	(maximum)	10.5m
(7)	Landscaped Open Space:	(minimum)	40%
(8)	Parking Requirements:	(minimum)	1 private garage per dwelling unit, attached to the dwelling unit

10.3.14 UR4-14 (See Zoning Map Part 10)

10.3.14.1 Permitted Uses

- (1) Accessory uses and buildings.
- (2) Multiple attached dwellings.

10.3.14.2 Site Zone Regulations

(1)	Lot Area:	(minimum)	300m² per dwelling unit
(2)	Lot Frontage:	(minimum)	9m per dwelling unit
(3)	Front Yard Depth:	(minimum)	4.5m , except that any vehicular entrance to an attached garage shall be located not less than 6m from the front lot line
(4)	Side Yard Widths:	(minimum)	- 1.2m where a dwelling abuts a Commercial Zone and 3m where a dwelling abuts a Residential Zone. - 3m exterior side yard, except that any vehicular entrance to an attached garage shall be located not less than 6m from any flanking street
(5)	Rear Yard Depth:	(minimum)	6m
(6)	Lot Coverage:	(maximum)	40%
(7)	Height:	(maximum)	10.5m
(8)	Landscaped Open Space:	(minimum)	40%
(9)	Parking Requirements:	(minimum)	1 private garage per dwelling unit attached to the dwelling unit
(10)	Special Regulations:	(minimum)	- any habitable dwelling shall be setback no less than 25m from the top of the bank of Lake Huron - no openings to any building shall be constructed below the 179.2m contour elevation (Canadian Geodetic System)

10.3.15 UR4-15 (See Zoning Map Parts 24, 62 and 63)

10.3.15.1 Permitted Uses

- (1) Accessory uses and buildings.
- (2) Multiple attached dwellings.
- (3) Semi-detached dwellings.
- (4) Single detached dwellings.

10.3.15.2 Site Zone Regulations

10.3.15.2.1 Single Detached Dwellings

- (1) All site regulations are as set out in Section 7.2.1.

10.3.15.2.2 Semi-Detached and Multiple Attached Dwellings

- | | | | |
|-----|--------------------|-----------|---|
| (1) | Lot Area: | (minimum) | <ul style="list-style-type: none"> - 240m² per semi-detached dwelling unit - 180m² per street multiple attached dwelling unit - 315m² per multiple attached dwelling unit |
| (2) | Lot Frontage: | (minimum) | <ul style="list-style-type: none"> - 8m per semi-detached dwelling unit - 6m per street multiple attached dwelling unit - 30m for all other multiple attached dwellings |
| (3) | Front Yard Depths: | (minimum) | <ul style="list-style-type: none"> - 4.5m for semi-detached and street multiple attached dwellings except that where an attached garage has a vehicular entrance that faces a municipal street, the minimum front yard shall be 6m - 10.5m for all other multiple attached dwellings |
| (4) | Side Yard Widths: | (minimum) | <ul style="list-style-type: none"> - 1.2m on both sides of a semi-detached dwelling attached above grade or both above and below grade, there is no interior side yard required along the common lot line where dwelling units are attached by a common wall, there is an interior side yard of 0.6m required along the common lot line for those portions of the dwelling units which are not attached by a |

- common wall
- **7.5m** on each side of all other multiple attached dwellings, except where the side of a multiple attached dwelling abuts a rear lot line, the minimum side yard shall be **3m**, there is no interior side yard required along the common lot line where the dwelling units are attached by a common wall, there is an interior side yard of **0.6m** required along the common lot line for those portions of the dwelling units which are not attached by a common wall
- **4m** exterior side yards adjacent to the flanking street for semi-detached and street multiple attached dwellings, except that where an attached garage has a vehicular entrance that faces a municipal street, a minimum side yard of **6m** shall be provided
- **7.5m** exterior side yard for all other multiple attached dwellings
- **1.2m** on both sides and there shall be a minimum interior side yard of **0.6m** required along the common lot line for semi-detached dwellings attached below grade only
- **3m** on both sides of a street multiple attached dwelling attached below grade, there is a minimum separation of **1.2m** required between dwelling units along common lot lines
- **3m** on both sides of a street multiple attached dwelling attached above grade or both above and below grade, there is an exterior side yard of **0.6m** required along the common lot line for those portions of the dwelling units which are not attached by a common wall

(5) Rear Yard Depth: (minimum) **7.5m**

- | | | | |
|------|--|-----------|---|
| (6) | Lot Coverage: | (maximum) | <ul style="list-style-type: none"> - 35% for semi-detached dwellings - 40% for street multiple attached and all other multiple attached dwellings |
| (7) | Height: | (maximum) | 10.5m |
| (8) | Landscaped Open Space: | (minimum) | 40% |
| (9) | Parking: | (minimum) | 1 private garage per dwelling unit, attached to the dwelling unit |
| (10) | Special Regulations:
(55/2005) | | <p>The dwellings in Registered Plan No. 25M-3 (Zoning Map Part 62) shall be subject to the following special regulations:</p> <ul style="list-style-type: none"> - a maximum height of 1 storey - a maximum of 2 bedrooms on the main floor of each dwelling unit; and - a minimum setback of 14m from Highway 40 |
| (11) | Special Regulations:
(85/2018) | | <p>The semi-detached dwellings in Registered Plan 637 (Zoning Map Part 63) shall be subject to the following additional special regulations:</p> <ul style="list-style-type: none"> - a maximum lot coverage of 45%; and - a minimum external side yard depth from a flanking street of 3 metres - a minimum rear yard depth for Lots 19-20, of 15 metres from Highway 40. |

10.3.16 UR4-16 (See Zoning Map Part 23)

10.3.16.1 Permitted Uses

- (1) Accessory uses and buildings.
- (2) Street multiple attached dwellings containing up to **7** dwelling units.

10.3.16.2 Site Zone Regulations

- | | | | |
|-----|-------------------|-----------|---|
| (1) | Lot Area: | (minimum) | 185m² per dwelling unit |
| (2) | Lot Frontage: | (minimum) | 6m per dwelling unit |
| (3) | Front Yard Depth: | (minimum) | 6m |
| (4) | Side Yard Widths: | (minimum) | 3m , except that where there is an attached garage or carport the minimum side yard width shall be |

(5)	Rear Yard Depth:	(minimum)	1.5m
(6)	Lot Coverage:	(maximum)	7.5m
(7)	Height:	(maximum)	45%
			10.5m

10.3.17 UR4-17 (See Zoning Map Part 29)

10.3.17.1 Permitted Uses

- (1) A **2** storey multiple attached dwelling only.
- (2) Accessory uses and buildings.

10.3.17.2 Site Zone Regulations

(1)	Number of Units:	(maximum)	36
(2)	Landscaped Open Space:	(minimum)	existing landscaping shall be maintained
(3)	Building Setbacks:	(minimum)	as existed on the date of passage of this By-law
(4)	Height:	(maximum)	7.3m
(5)	Parking:	(minimum)	45 spaces
(6)	Access:	(minimum)	a pedestrian and emergency access shall be provided from the south portion of the lands to Eastwood Avenue

10.3.18 UR4-18 (See Zoning Map Part 21)

10.3.18.1 Permitted Uses

- (1) Those uses permitted in Section 10.1.

10.3.18.2 Site Zone Regulations - Existing 9 Unit Multiple Attached Dwelling

(1)	Side Yard:	(minimum)	0 east side yard
(2)	Parking:	(minimum)	10 parking spaces

10.3.19 UR4-19 (See Zoning Map Part 63)

(143/2004)

10.3.19.1 Permitted Uses

- (1) Accessory uses and buildings.
- (2) Multiple attached dwellings.
- (3) Semi-detached dwellings.
- (4) Street multiple attached dwellings.

10.3.19.2 Site Zone Regulations

- (1) All site regulations are as set out in [Section 10.3.15.2.2](#).

10.3.20 UR4-20 (See Zoning Map Part 19)

(84/2005 - OMB Approved)

10.3.20.1 Permitted Uses

- (1) Accessory uses and buildings.
- (2) Multiple attached dwellings.
- (3) Single detached dwellings.
- (4) Semi-detached dwellings.

10.3.20.2 Site Zone Regulations

10.3.20.2.1 Golf Course Residential Community Lots

For the purposes of this By-Law, the regulations associated with the term “Lot” as specified for a Golf Course Residential Community Lot including lot area, lot frontage, lot coverage and all yard requirements shall apply to the area associated with a permitted dwelling unit and shall not have the same meaning as a “Lot” or its associated terms as defined individually in Section 2 of Zoning By-Law No 85 of 2002.

10.3.20.2.2 Single Detached and Semi-Detached Dwellings

- | | | | |
|-----|-----------------|-----------|----------------------------------|
| (1) | Lot Area: | | |
| | Single detached | (minimum) | 300m² |
| | Semi-detached | (minimum) | 150m² per unit |
| (2) | Lot Frontage: | | |
| | Single detached | (minimum) | 10m |
| | Semi-detached | (minimum) | 9m per unit |

(3)	Front Yard Depth:	(minimum)	4m , except that any vehicular entrance to an attached garage shall be not less than 6m from the front lot line of the Golf Course Residential Community Lot.
(4)	Side Yard Widths:		
	Single detached	(minimum)	1.2m each side except that where there is no attached garage or carport one side yard shall be 3.0m .
	Semi-detached	(minimum)	1.2m each side except that where there is no attached garage or carport one side yard shall be 3.0m . There is no interior side yard required along the common lot line where dwelling units are attached by a common wall. Where those portions of the dwelling units are not attached by a common wall, a setback of 0.6m from the common lot line shall be required.
(5)	Rear Yard Depth:	(minimum)	6m
(6)	Setback from Howard Watson Nature Trail:	(minimum)	Notwithstanding any other setbacks established by this Zone, a minimum 7.5m building setback shall be required from the Howard Watson Nature Trail.
(7)	Lot Coverage:	(maximum)	40%
(8)	Height:	(maximum)	12m
(9)	Setbacks from Golf Course Playing Area:		Appropriate setbacks from the golf course playing area shall be established through site plan / plan of condominium approval.
(10)	Special Building Setbacks:	(minimum)	No dwelling shall be constructed within 7.5m of the east or west property line of the golf course.

10.3.20.2.3 Multiple Attached Dwellings

(1)	Lot Area:	(minimum)	180m² for each unit
(2)	Lot Frontage:	(minimum)	20m
(3)	Front Yard Depth:	(minimum)	6m
(4)	Side Yard Widths:	(minimum)	3m each side. There is no interior side yard required along the common lot line where dwelling units are attached by a common

			<p>wall. Where those portions of the dwelling units are not attached by a common wall, a setback of 0.6m from the common lot line shall be required.</p>
(5)	Rear Yard Depth:	(minimum)	6m
(6)	Setback from Howard Watson Nature Trail:	(minimum)	Notwithstanding any other setbacks established by this Zone, a minimum 7.5m building setback shall be required from the Howard Watson Trail.
(7)	Lot Coverage:	(maximum)	40%
(8)	Height:	(maximum)	12m
(9)	Setbacks from Golf Course Playing Area:		Appropriate setbacks from the golf course playing area shall be established through site plan / plan of condominium approval.
(10)	Special Building Setbacks:	(minimum)	No dwelling shall be constructed within 7.5m of the east or west property line of the golf course.

10.3.21 UR4-21 (See Zoning Map Part 24)

(48/2007)

10.3.21.1 Permitted Uses

- (1) Accessory Uses and Buildings.
- (2) Duplex Dwellings.
- (3) Semi-detached dwellings.
- (4) Single detached dwellings.
- (5) Multiple attached dwellings.
- (6) Group Homes.
- (7) Places of Worship.
- (8) Women's Shelters.
- (9) Schools.
- (10) Child-care Centre.

(79/2020)

10.3.21.2 Site Zone Regulations

10.3.21.2.1 Single detached dwellings, Group Homes and Women's Shelters

(19/2009)

- | | | | |
|-----|-------------------|-----------|--|
| (1) | Lot Area: | (minimum) | 400m² |
| (2) | Lot Frontage: | (minimum) | 12m |
| (3) | Side Yard Widths: | (minimum) | 1.2m on one side and 3m on the other side, except that where there |

(4) All Other Regulations:

is an attached garage or carport, the minimum side yard width shall be **1.2m** on each side the regulations set out in [Section 7.2.1](#) shall apply

10.3.21.2.2 Places of Worship

The regulations set out in Section 7.2.2 shall apply.

10.3.21.2.3 Day care Centres

The regulations set out in Section 7.2.3 shall apply.

10.3.21.2.4 Duplex dwellings and semi detached dwellings

The regulations set out in Section 8.3.1.1 shall apply.

10.3.21.2.5 Multiple attached dwellings

The regulations set out in Section 10.3.15.2.2 shall apply.

10.3.21.2.5 Schools

(79/2020)

The regulations set out in Section 7.2.2 shall apply.

10.3.22 UR4-22 (see zoning map Part 24)

(48/2007)

10.3.22.1 Permitted Uses

- (1) Accessory Uses and Buildings.
- (2) Apartment buildings.
- (3) Duplex Dwellings.
- (4) Semi-detached dwellings.
- (5) Single detached dwellings.
- (6) Multiple attached dwellings.
- (7) Group Homes.
- (8) Place of Worship.
- (9) Women's Shelters.

10.3.22.2 Site Zone Regulations

10.3.22.2.1 Apartment dwellings

The regulations set out in Section 11.2.1 shall apply, except that the maximum height shall be limited to **3** storeys and that no building or structure shall be permitted within **14m** from the **Highway 40** and **Highway 402** property lines.

10.3.22.2.2 Single detached dwellings, Group Homes and Women's Shelters**(19/2009)**

- | | | | |
|-----|---|-----------|--|
| (1) | Lot Area: | (minimum) | 400m² |
| (2) | Lot Frontage: | (minimum) | 12m |
| (3) | Side Yard Widths: | (minimum) | 1.2m on one side and 3m on the other side, except that where there is an attached garage or carport, the minimum side yard width shall be 1.2m on each side |
| (4) | All Other Regulations: The regulations set out in Section 7.2.1 shall apply except that no building or structure shall be permitted within 14m from the Highway 40 and Highway 402 property lines. | | |

10.3.22.2.3 Places of Worship

The regulations set out in [Section 7.2.2](#) shall apply except that no building or structure shall be permitted within **14m** from the **Highway 40** and **Highway 402** property lines.

10.3.22.2.4 Day care Centres

The regulations set out in [Section 7.2.3](#) shall apply except that no building or structure shall be permitted within **14m** from the **Highway 40** and **Highway 402** property lines.

10.3.22.2.5 Duplex dwellings and semi detached dwellings

The regulations set out in [Section 8.3.1.1](#) shall apply except that no building or structure shall be permitted within **14m** from the **Highway 40** and **Highway 402** property lines.

10.3.22.2.6 Multiple attached dwellings

The regulations set out in [Section 10.3.15.2.2](#) shall apply except that no building or structure shall be permitted within **14m** from the **Highway 40** and **Highway 402** property lines.

10.3.23 UR4-23 (see zoning map Part 15) (104/2016)

10.3.23.1 Permitted Uses

- (1) Multiple Attached Dwellings

10.3.23.2 Site Zone Regulations

10.3.23.2.1 Multiple Attached Dwellings

- | | | |
|----------------------------|-----------|---|
| (1) Lot Area: | (minimum) | 460m² for each unit |
| (2) Lot Frontage: | (minimum) | 13m |
| (3) All Other Regulations: | | The regulations set out in <u>Section 10.2.1</u> shall apply. |
-

10.3.24 UR4-24 (see zoning map Part 24) (69/2019)

10.3.24.1 Permitted Uses

- (1) Accessory Uses and Buildings.
- (2) Duplex Dwellings.
- (3) Semi-detached Dwellings.
- (4) Single Detached Dwellings.
- (5) Multiple Attached Dwellings.
- (6) Group Homes.
- (7) Places of Worship.
- (8) Women's Shelters.

10.3.24.2 Site Zone Regulations

10.3.24.2.1 Single Detached Dwellings, Group Homes and Women's Shelters

- | | | |
|----------------------------|-----------|---|
| (1) Lot Area: | (minimum) | 400m² |
| (2) Lot Frontage: | (minimum) | 12m |
| (3) Side Yard Widths: | (minimum) | 1.2m on one side and 3m on the other side, except that where there is an attached garage or carport, the minimum side yard width shall be 1.2m on each side |
| (4) All Other Regulations: | | The regulations set out in <u>Section 7.2.1</u> shall apply except that no building or structure shall be permitted within 14m from the Highway 402 property lines. |

10.3.24.2.2 Duplex Dwellings and Semi-detached Dwellings

- (1) The regulations set out in Section 8.3.1.1 shall apply except that no building or structure shall be permitted within **14m** from the **Highway 402** property lines.

10.3.24.2.3 Multiple Attached Dwellings

- (1) The regulations set out in Section 10.3.15.2.2 shall apply except that no building or structure shall be permitted within **14m** from the **Highway 402** property lines.

10.3.24.2.4 Places of Worship

- (1) The regulations set out in Section 7.2.2 shall apply except that no building or structure shall be permitted within **14m** from the **Highway 402** property lines.

10.3.25 UR4-25 (see zoning map Part 63)**(55/2019)****10.3.25.1 Permitted Uses**

- (1) Accessory Uses and Buildings.
- (2) Semi-detached Dwellings.
- (3) Single Detached Dwellings.
- (4) Multiple Attached Dwellings.

10.3.25.2 Site Zone Regulations**10.3.25.2.1 Single Detached Dwellings**

- (1) All regulations as set out in Section 7.2.1 shall apply.

10.3.25.2.2 Semi-detached Dwellings

- | | | |
|-------------------------------|-----------|--|
| (1) Lot Coverage: | (maximum) | 40% |
| (2) Exterior Side Yard Width: | (minimum) | 3.0m |
| (3) Rear Yard Depth: | (minimum) | 7.5m , with the exception that a semi-detached dwelling on Lot 6 may have a rear yard depth of 6.0m |

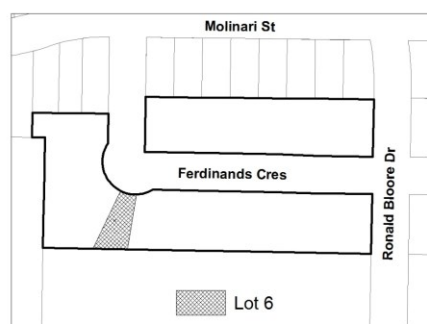

(4) All Other Regulations:

The regulations set out in Section 10.3.15.2.2 shall apply.

10.3.25.2.3 Multiple Attached Dwellings

(1) All regulations as set out in Section 10.3.15.2.2 shall apply.

10.3.26 UR4-26 (see zoning map Part 42)

(81/2021)

10.3.26.1 Permitted Uses

- (1) Accessory uses.
- (2) Multiple dwelling containing a maximum of 15 dwelling units.
- (3) Theatre.

10.3.26.2 Site Zone Regulations

(1) Lot Area:	(minimum)	as it existed on the date of the passing of this by-law.
(2) Lot Frontage:	(minimum)	as it existed on the date of the passing of this by-law.
(3) Front & Rear Yards:	(minimum)	as it existed on the date of the passing of this by-law.
(4) Side Yards:	(minimum)	as it existed on the date of the passing of this by-law.
(5) Lot Coverage:	(maximum)	as it existed on the date of the passing of this by-law.
(6) Height:	(maximum)	as it existed on the date of the passing of this by-law.
(7) Landscaped Open Space:	(minimum)	21%
(8) Parking:	(minimum)	80 spaces.
(9) Planting Strips:	(minimum)	3m along the north and east lot lines adjacent to the parking areas.

10.3.27 UR4-27 (see zoning map Part 56)**(94/2023)****10.3.27.1 Permitted Uses**

(1) As set out in Section 10.1

10.3.27.2 Site Zone Regulations – Multiple Attached Dwellings

- | | | |
|----------------------------|-----------|--|
| (1) Lot Area: | (minimum) | 160m² for each unit |
| (2) Lot Frontage: | (minimum) | 22.0m |
| (3) Side Yard Width: | (minimum) | 1.8m |
| (4) Private Amenity Space: | (minimum) | The provisions in subsection 10.2.1(9) of this By-law do not apply. |
| (5) Parking: | (minimum) | 1.2 spaces per unit |
| (6) Planting Strips: | (minimum) | 1.5m along the lot line of adjoining residential lots. |
| (7) All Other Regulations: | | As set out in Section 10.2.1 |

10.3.27.3 Site Zone Regulations – All Other Permitted Uses

(1) As set out in Section 10.2

10.3.28 UR4-28 (see zoning map Part 14)**(109/2024)****10.3.28.1 Permitted Uses**

1. As set out in Section 10.1.

10.3.28.2 Site Zone Regulations – Apartment Dwellings

- | | | |
|---------------------------|-------|---|
| 1. Lot Area | (min) | As existed on the date of the passing of this By-law. |
| 2. Side Yard Width | (min) | As existed on the date of the passing of this By-law. |
| 3. Parking | (min) | 1.5 spaces per unit |
| 4. Planting Strip | (min) | As existed on the date of the passing of this By-law. |
| 5. All other regulations, | | as set out in Section 10.2.2 |

10.3.28.3 Site Zone Regulations - All Other Permitted Uses

1. As set out in Section 10.2.